

Enterprise Endpoint Backup



Users always store business data on laptops and desktops, even when they shouldn't. The adoption of corporate laptops and “bring your own device” only increases the amount of data stored on these endpoint devices, creating more complexity and greater challenges for IT departments mandated to safeguard the business from crippling data loss.

Here's the good news: data loss incidents can be more bearable if you know you're doing everything possible to minimize your organization's risk—which means sufficiently protecting all the corporate data and intellectual property stored on endpoints.

BACK UP EVERYONE, EVERYWHERE

Designed for the needs of today's enterprise, CrashPlan endpoint backup empowers a single admin to easily support thousands of employees, while allowing non-technical users to quickly, easily access and restore data without IT intervention. Running invisibly and continuously in the background, CrashPlan protects all critical business data stored on laptops and desktops, regardless of platform. And its real-time dashboard gives IT peace of mind that all employee endpoints back up as expected.

CrashPlan protects millions of devices and more than four exabytes of data globally. In fact, some of the world's top brands—including Accenture, Adobe, Netflix, Procter & Gamble, Salesforce, SanDisk, Target, TaylorMade and The Ohio State University—trust CrashPlan to safeguard their sensitive information.

SECURITY AND FLEXIBILITY WITHOUT COMPROMISE

Three primary cloud deployment strategies exist today for enterprise software: public cloud, private cloud and hybrid cloud. Yet, many endpoint backup vendors force enterprises to use the vendor's preferred cloud approach, or risk sacrificing data security.

CrashPlan from Code42 is different. CrashPlan meets both requirements—securely and seamlessly. A powerful and highly flexible solution, CrashPlan lets you confidently choose your preferred cloud deployment strategy, knowing all meet or exceed rigorous industry standards for data security.

Flexible data storage with robust security. All CrashPlan cloud deployment strategies allow for encryption keys to be kept on-premises, behind your firewall.

Iron-clad, end-to-end encryption. Data is encrypted on the endpoint before transmission and remains encrypted in-transit and at rest. CrashPlan also encrypts the metadata.

On-premises deployment with comprehensive services. CrashPlan Managed Private Cloud gives you full data control through a private cloud deployment combined with the management ease of a public cloud. A finely tuned, high-performance CrashPlan appliance resides on-premises and is monitored/managed 24x7 by Code42's Customer Champion team.

Compliant security model keeps you in control. There's never a need to expose your directory services to the Internet. Integrations with single sign-on and identity management streamline user administration and management.

PROVEN PERFORMANCE AND SCALABILITY

Consistently recognized as the top solution available today for personal and business backup, CrashPlan currently protects exabytes of data across millions of devices and for leading organizations worldwide. These industry frontrunners know only CrashPlan can scale to meet all their future needs; from tens to thousands or even millions of desktops and laptops—CrashPlan's elasticity, reliability and security scale to ensure enterprise data remains protected at all times.

Silent, continuous backups. CrashPlan runs invisibly in the background, allowing users to work without interruption and ensuring round-the-clock data protection.

Automatic, optimized storage management. Designed to easily scale to support hundreds of thousands of users, CrashPlan's automatic data balancing, I/O balancing and smart assignment rules fully optimize storage and bandwidth. CrashPlan also scales without excessive hardware requirements.

Unlimited means unlimited. With CrashPlan, there's no need to compromise backup policies to fit arbitrary limits. Keep an unlimited number of versions and even deleted files forever, with no restriction on size, number, frequency or type of files.

Bandwidth-friendly. CrashPlan's variable, block-level de-duplication occurs on the client, so only changed bytes of data are transmitted.

Easy expansion. Need more capacity? Simply add another server, and CrashPlan automatically distributes data and I/O to optimize backup performance.

PROACTIVE, REAL-TIME ADMINISTRATION

With CrashPlan, a single admin can support thousands of users on a variety of platforms. And, real-time access and visibility into backup operations give you the information needed to immediately take action wherever necessary.

Centralized console for the entire enterprise. A centralized management console lets you manage the entire enterprise—including policies, profiles and data retention—for all platforms from a single pane of glass.

Comprehensive visibility across all endpoints, regardless of platform. Cross-platform support allows you to reduce costs and complexity by backing up all platforms in use at your organization—Linux, Mac, Windows and Solaris—and manage them from a single console. And CrashPlan's consistent user experience across platforms means less time training end users and answering support tickets.

Real-time dashboard and custom reporting for accurate insight. CrashPlan's administration console provides real-time data on the status of your endpoint backups. The same API that drives the admin console can be used to integrate backup information with your own tools, for building custom reports.

Self-service data restore eliminates IT bottlenecks. Your users can easily restore data on their own via a variety of easy methods, without needing IT help.



Phased roll-outs ensure successful upgrades. You decide when users upgrade; test on a small group before pushing out to your entire business.

EASE-OF-USE FOR END USERS

Users work as they normally do—no need to manually initiate backups—while CrashPlan quietly, invisibly and continuously guards their data. And, CrashPlan’s streamlined user interface makes it easy for end users to locate and restore their data; it’s as easy as browsing folders to locate the data to be accessed or restored.

Continuous, invisible backup protects all data. CrashPlan runs quietly and continuously, with no forced “backup breaks” or manual intervention.

Self-service restore saves time for IT and end users. Users easily restore their files via an intuitive interface on desktop, mobile and web—no training necessary.

Get files on-the-go with mobile access. CrashPlan’s mobile apps for iOS, Android, Windows and Amazon Kindle Fire provide a hassle-free way for users to access files wherever they may be.

Adjustable backup settings keep CrashPlan “device-friendly.” If desired, users can adjust backup settings to best fit their device and network profiles.

APPLICATIONS

CrashPlan’s flexible architecture naturally lends itself to uses beyond endpoint backup and restore.

Mobile file access. CrashPlan gives users secure access to their backed up files from any iOS, Android, Windows or Amazon Kindle Fire mobile device, making it easy to stay productive while on-the-go.

Data migration. Migrating data to new operating systems, devices and even between platforms—such as Windows to Mac—is easy thanks to CrashPlan’s “platform-enthusiastic” nature and ability to protect all the enterprise data stored on endpoints.

Legal hold and compliance. CrashPlan’s unlimited data retention settings, granular controls, real-time dashboard and admin-initiated push restores allow you to retain all previous versions of files, offering an easy way to ensure your organization meets compliance and legal requirements.

Disaster recovery. Data disasters can strike at any moment. CrashPlan continuously and reliably protects enterprise data, so it can be easily recovered whenever and wherever needed.

UNMATCHED PROFESSIONAL EXPERTISE

CrashPlan is supported and managed by Code42 professionals possessing years of deep technical experience and knowledge. We’re here to make sure you get the most from your CrashPlan implementation.

Professional Services. Code42 Advisory Services speed your CrashPlan deployment and ensure its ongoing success via access to best practices and subject matter expertise.

Customer Champions. Our Customer Champion team is available 24x7x365 and maintains a 96 percent customer satisfaction rating.

World’s largest endpoint backup cloud. Code42 manages and protects more than four exabytes of data across millions of devices worldwide. Since we operate and manage our own clouds, our deep cloud expertise directly translates into robust enterprise solutions that minimize cost and risk, maximize investment and performance, and simplify administration.

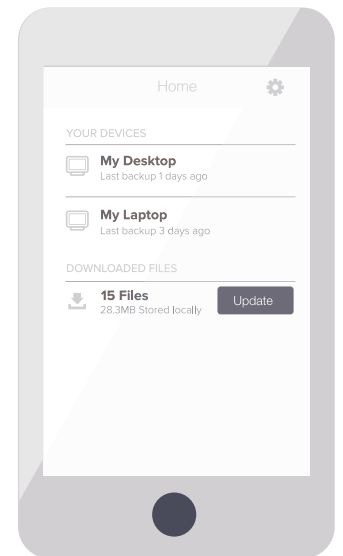

KEY BENEFITS

FOR IT

Flexible infrastructure. Back up to public or private cloud destinations—or both, for easy redundancy and high availability.

End-to-end security. Data is encrypted on the device, and remains encrypted in-transit and at rest. Additionally, you can choose to keep control of the encryption keys, even when deploying via public cloud.

Proven scalability. Easily add new storage nodes that auto-balance quickly to increase your backup capacity. The same technology supports more than a million devices in CrashPlan's public cloud.

Simple administration. Manage users and destinations from one, easy-to-use admin console. Apply policies and view the status of backups in real-time.

Seamless, cross-platform support. Support all users with one backup solution that works the same on Windows, Mac, Linux and Solaris.

Authentication technology integrations. Assign policies automatically based on your existing LDAP structure. Allow users to log in with their existing credentials.

FOR EMPLOYEES/END USERS

Automatic, invisible protection. Runs quietly in the background, with no training necessary. Users won't notice CrashPlan until it's time to restore.

Simple, consistent user interface. Consistent user experience, regardless of platform used.

Self-service restore. No waiting for IT; your users can restore their own files at any time, using a variety of easy methods.

Mobile access. Stay productive on-the-go by accessing files from any mobile device.

KEY FEATURES

Multi-destination redundancy

Variable, block-level de-duplication

Data encryption in-transit and at rest

Cross-platform support for Mac, Linux, Solaris and Windows

Unlimited backups

Adjustable backup frequency

Flexible file selection

Laptop-friendly performance control

Policy-driven user settings

Customizable installers

Web, push and self-service data restores

Single sign-on/identity management integration

Unified, real-time admin console

Customizable reporting using REST API

Automatic data balancing

Self-healing archives



CODE 42

CORPORATE HEADQUARTERS

1 MAIN STREET SE #400

/ MINNEAPOLIS, MN 55414

/ 612.333.4242

/ WWW.CRASHPLANPROE.COM/CONTACT

/ WWW.CODE42.COM

Code42 has been developing technology solutions to protect and manage the world's data since 2001. More than 5,000 companies globally—many of them the largest organizations in the world, including Adobe, Target, Groupon, HP, P&G, Netflix, Under Armour, Intuit, Stanford University, Genentech/Roche, Kraft Foods, Harvard University, SUPERVALU, NASA and The University of Texas—trust Code42 with their enterprise endpoint backup and file sync/share needs. For more information, visit www.code42.com. OV091306